

**STEEL MILL**



**OIL & GAS**

**KABELSCHLEPP**

**MACHINE TOOL**

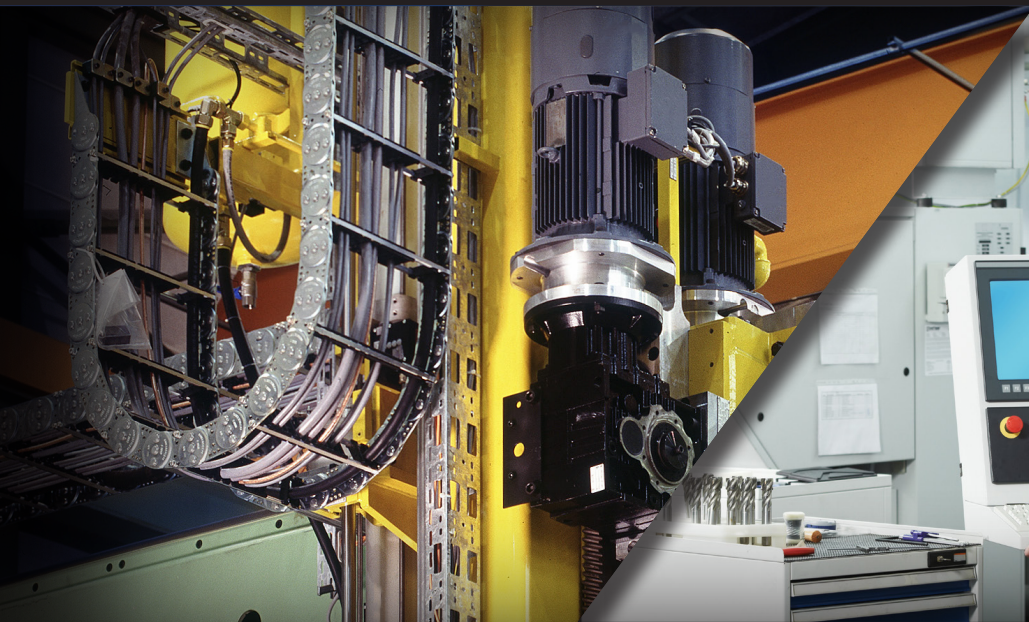

**READY TO GO**



# Steel Mill

***Kabelschlepp develops customized solutions for steel works and rolling mills.***

We have decades of experience, and our cable and hose carriers are installed on hundreds of applications at steel process plants across Canada. Our team of specialists will work with you on the plan and design of your system, and guide you through installation and start-up to ensure optimized trouble-free operation.



***Heavy-Duty. Heat Resistant. Lubrication-Free.***

## Steel Applications

- Turntables and turning devices
- Lift and tilt frame devices
- Walking beams
- Slab crane systems
- Rotary stacker and reclaimer applications
- Scissor type lifting devices
- Oxy cut off trolley
- Coil banding buggies
- Forging manipulators
- Metal turning lathes

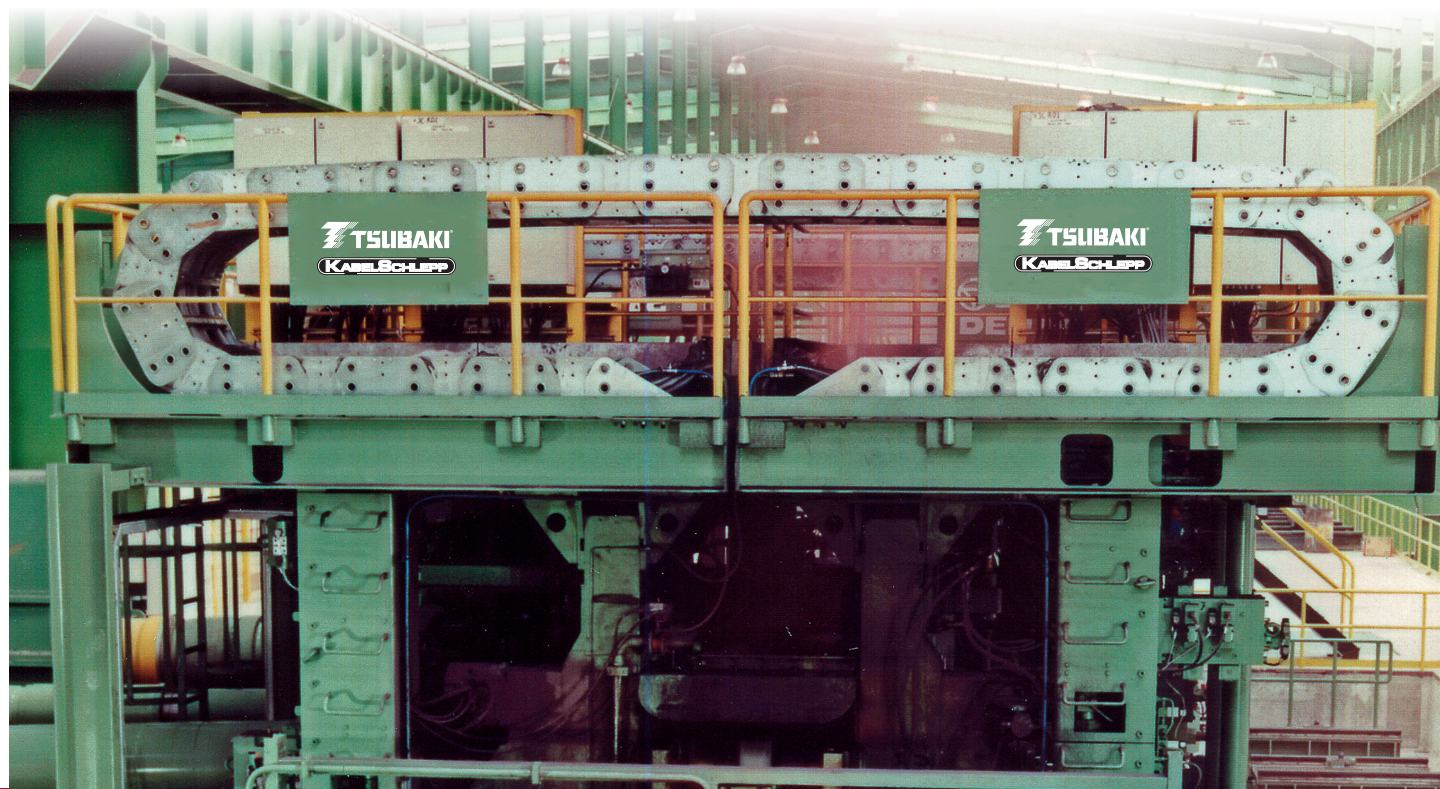

# Oil & Gas

***Kabelschlepp specializes in extreme duty cable carriers for hose and cable management.***

Our components are readily available off the shelf and assembled into specified “made to order” configurations. Our engineering team will work with you to design the right solution for your demanding application. The materials we use are chosen to withstand the rigors of harsh weather and mechanically challenging applications. The mission is to provide you with a reliable system that will last years of operation.

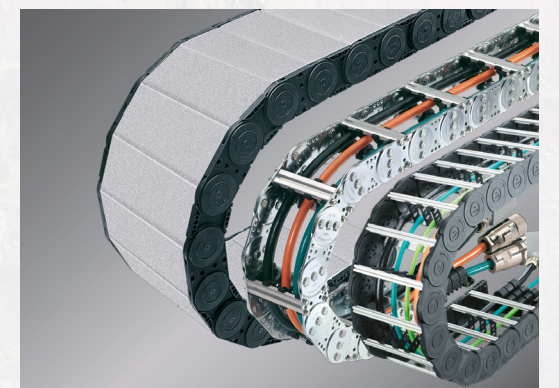

## Oil & Gas Applications

- Cranes
- Platform E/W and N/S Rig Module Skidding
- Jackups
- Deck – Cantilever Skidding
- Data, Sensor, Power and other Cable
- Cantilever – Drill Floor Travel
- Cantilever X - Y Skidding
- Riser Pipe Handling
- BOP Handling
- Fire & Low Pressure Hoses
- High Pressure Mud & Cement Hoses
- Christmas Tree Transport
- Top Drive
- Personnel and Service Bridges
- DP Thruster Raise/Lower
- Land Rig Skidding
- Substructure – Drill Floor Skid



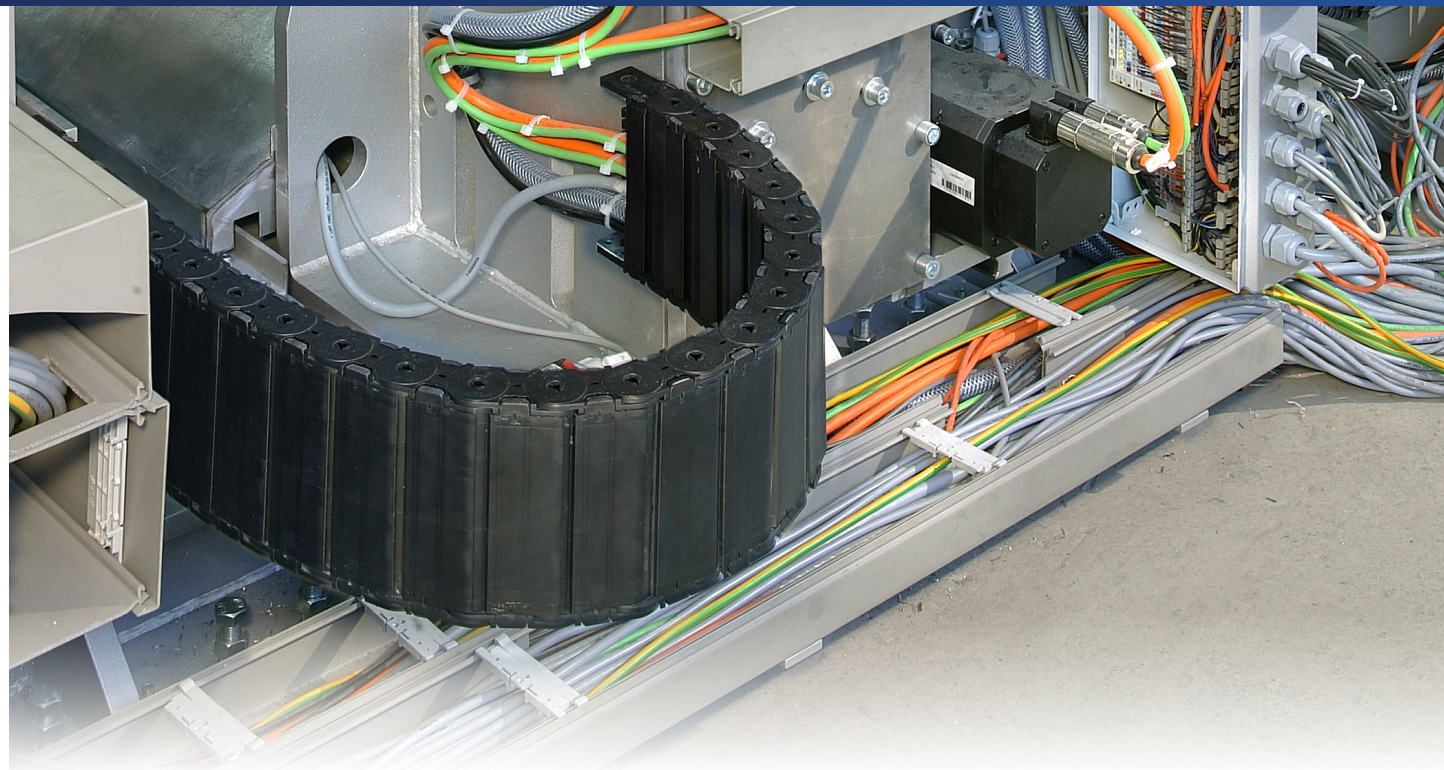

# Machine Tool

**Whether you require cable carriers made of plastic or steel, linear or 3-D movement, Kabelschlepp has you covered.**

Kabelschlepp invented dynamic hose and cable carriers in 1954 with the invention of the steel cable carrier. As a complete solution provider, Kabelschlepp can provide fully populated systems including cables, cable carriers and support trays that meet your individual needs.



## Machine Tool Applications

- CNC Machining Centers
- Lathes and Metal Turning
- Multi-Axis Robot Applications
- Weld cells
- X, Y, Z, Gantry Cranes & 3D Printer
- Linear Sliding Platforms
- Plasma Cutting Table
- Portable Sawmills
- Plastic Injection Molding Machines

# Ready To Go

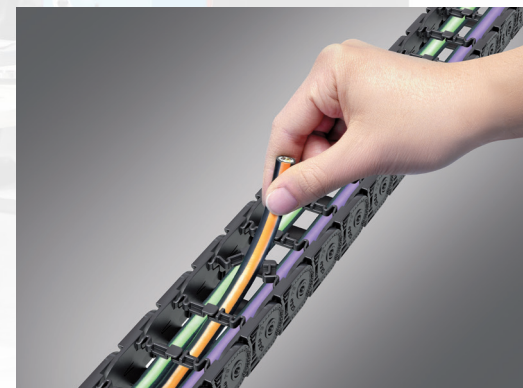
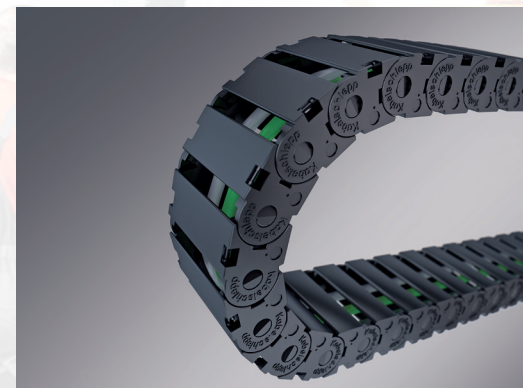

***Tsubaki Kabelschlepp has a long history of excellence and leadership in bringing innovative products to the market and, since 1981, cable carriers have been manufactured and shipped from the USA.***

Now, Tsubaki of Canada Limited will be stocking main components of our standard series carriers in order to fulfill faster delivery, and to continue to provide fair pricing to our customers.

This inventory of cable carriers includes different products, with simple design and fixed-widths (predefined chain widths). All product types are easy to install, have a robust and reliable design and offer an excellent price-performance ratio.





# Conduflex Cross Guide

After decades of service, the Conduflex product is being retired from Kabelschlepp's product offering. In order to assist you in repairing your equipment, we have provided this cross over chart which shows similar sized enclosed plastic cable carriers that closely match the footprint of the various sized Conduflex.

Please note that the sizes are not exact and will not match bolt patterns on existing installs. If you require consultation, please contact Tsubaki of Canada.

### TKA Series

Withstands incidental contact with hot chips and sparks up to 400°C and constant heat up to 235°C.

### MT Series

Enclosed cable carrier with plastic sidebands and aluminum lids.

### CF 085

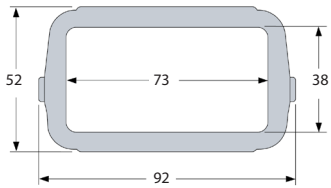

Bend Radius KR	Mounting Height H
100	252
150	352
200	452
250	552

### TKA 45-75 Bi

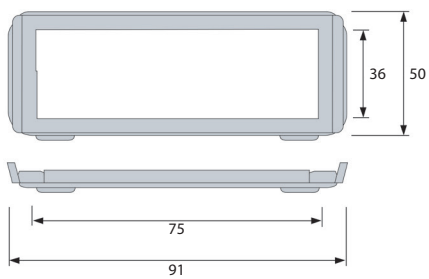

Bend Radius KR	Mounting Height H
82	214
95	240
125	300
145	340
170	390
200	450
230	520

## Small Conduflex to TKA Enclosed Plastic

## Large Conduflex to MT Enclosed Plastic

### CF 055

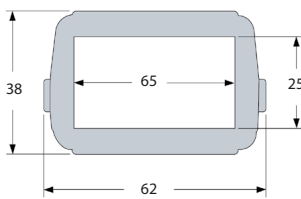

Bend Radius KR	Mounting Height H
65	168
100	238
150	338

### TKA 38-38,58 Bi

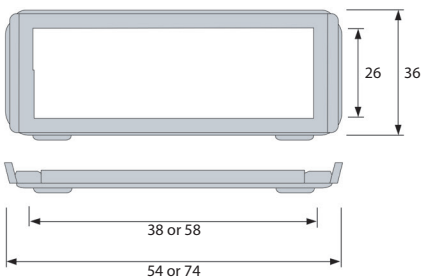

Bend Radius KR	Mounting Height H
70	176
95	226
120	276
145	326
170	376
195	426
230	496

### CF 060

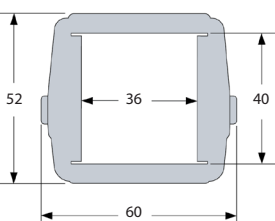

Bend Radius KR	Mounting Height H
100	252

### TKA 55-50 Bi

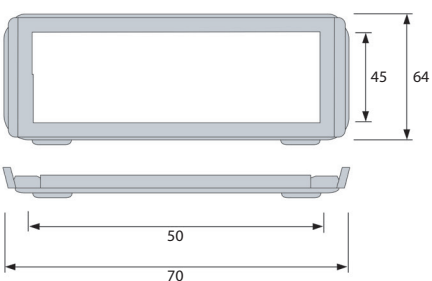

Bend Radius KR	Mounting Height H
100	264

### CF 115

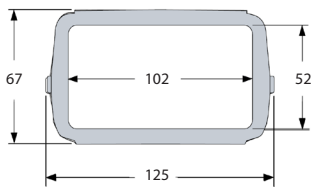

Bend Radius KR	Mounting Height H
140	347
225	517
300	667

### MT 0950

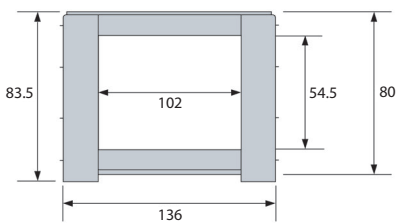

Bend Radius KR	Mounting Height H
140	360
170	420
200	480
260	600
290	660

### CF 120 / CF 175

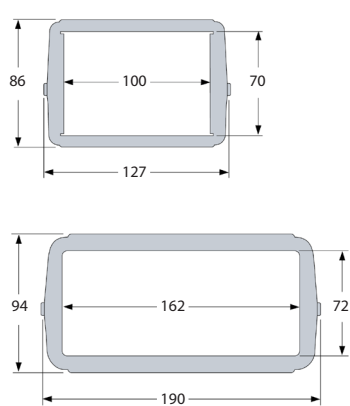

	Bend Radius KR	Mounting Height H
CF 120	155	396
	200	486
CF 175	185	464
	250	594
	350	794

### MT 1250

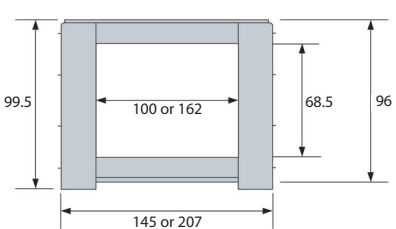

Bend Radius KR	Mounting Height H
220	536
260	616
300	696
340	776
380	856
500	1096



# How To Order

Inner Width

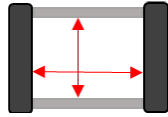

Inner Height

Outer Width

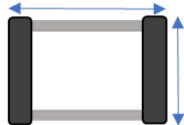

Outer Height

Guide Tray Width  
(If applicable)

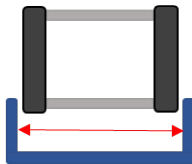

## Length of Chain Dimensions (2 methods)

Carrier Pitch

Total # Pitches  
(minus end brackets)

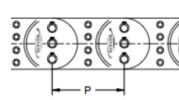

Total Travel\*  
(inches or mm)

Fixed Mount

(CENTER or END of travel)

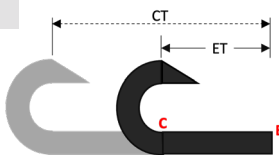

Loop Height

Driver Arm Height  
(If different)



## Mounting Bracket Type

☐ Diagonal Style Comb

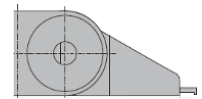

☐ Universal Style

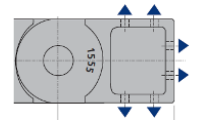

Circle Desired  
Mounting Position

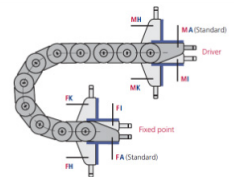

Notes: \_\_\_\_\_  
 \_\_\_\_\_  
 \_\_\_\_\_  
 \_\_\_\_\_  
 \_\_\_\_\_  
 \_\_\_\_\_  
 \_\_\_\_\_  
 \_\_\_\_\_



**Tsubaki of Canada Limited**  
 HEAD OFFICE & MANUFACTURING PLANT  
 1630 Drew Road  
 Mississauga, Ontario CANADA L5S 1J6  
 Tel: (800) 263-7088  
 www.tsubaki.ca



**Edmonton Office & Warehouse**  
 10035 56th Avenue  
 Edmonton, AB CANADA T6E 5L7  
 Tel: (800) 661-8811



**Maple Ridge Manufacturing Plant**  
 9475 288th Street  
 Maple Ridge, BC CANADA V2W 1L1  
 Tel: (800) 462-3866



**U.S. Tsubaki Power Transmission, LLC**  
 301 E. Marquardt Drive  
 Wheeling, IL USA 60090  
 Tel: (800) 323-7790



**Cable & Hose Carrier Division**  
 7100 W. Marcia Road  
 Milwaukee, WI USA 53223  
 Tel: (800) 443-4216